



# TITAN™ 100W

## 100,000 Amp Panel Protection

EFI Titan 100W is a multi-phase surge suppressor and noise filter in a compact and affordable package. The compact design of the Titan 100W allows protection to be installed adjacent to power panels or directly on sensitive equipment to protect against damage and disruption in the worst electrical conditions.



### APPLICATIONS

The Titan 100W is a versatile and compact surge protection device designed to provide high quality protection for a wide variety of commercial, industrial or institutional applications. The Titan 100W is excellent as a component in a suppression network or as a standalone protector.

### SUPERIOR PERFORMANCE

The 100W utilizes a high energy suppression circuit that provides 100,000 peak amps of surge protection per phase along with EFI's sine wave tracking circuitry that provides up to -40dB of noise attenuation.

### SAFETY

The EFI Titan 100W is engineered to be the industries safest surge protection device with unique fusing technology designed for these high energy surge products.

### EASY INSTALLATION

The EFI Titan 100W mounts adjacent to the panel through a direct nipped connection. The 100W allows flexible mounting near the circuit breaker to be used in order to reduce lead lengths and improve protection.

FEATURES	ADVANTAGES	BENEFITS
Compact Design	Easily mounts even in restricted spaces	Improves quality of protection
100,000 Peak Amp Capacity	Provides protection against high energy nearby lightning strikes	Keeps valuable electronics safe even in the worst electrical conditions
Sine Wave Tracker™ Circuitry	Suppresses transients closer to the sine wave	Improves protection to the equipment
LED Status Indication	Provides visual indication of the suppressor status	Allows immediate response if suppressor is damaged
Suppression Status Alarm	Provides immediate alarm if suppression is ever damaged	Prevents operating without protection
LightningTemp® Fuse	Thermal fuse capable of extreme surge currents	Provides reliable operator and prevents dangerous thermal run-a-way when MOV's are damaged

# TITAN 100W

## Product Specifications

**MODELS AVAILABLE** 100W100/240, 100W120/208, 100W240, 100W240/120, 100W220/380, 100W277/480, 100W480, 100W347/600, 100W600

### PERFORMANCE

Max Surge Current 100KA/phase, L-N 50KA, L-G 50KA, N-G 50KA  
EMI/RFI Noise Rejection Up to -40dB  
Sine Wave Tracking Yes

### MECHANICAL DESCRIPTION

Dimensions 2.6" x 4.75" x 10.6"  
Housing Ratings NEMA 1  
Product Weight 2 lb  
Connection Method #10 AWG Terminals  
Mounting Method Closed Nippled  
Thermal Fusing Yes, LightningTemp® Fuse  
Operating Frequency 50/60/400 Hz  
Circuit Type Parallel Hybrid  
Storage Temperature -40° to +160° F (-40° to +70° C)  
Operating Temperature -40° to +140° F (-40° to +60° C)  
Operating Altitude Sea Level to 12,000 feet (3,658 Meters)

### DIAGNOSTICS

Standard Green Status LED, Dry Contacts, Audible Alarm

### SAFETY APPROVALS

UL 1449 2nd Edition, cUL, CE

### WARRANTY

Product 10 years

## Titan 100W SYSTEM DESCRIPTION AND SAFETY RATINGS

Model	Configuration	MCOV	UL 1449-2 Ratings				ANSI C62.41 Clamping Voltage		
			(L-N)	(L-G)	(N-G)	(L-L)	CAT A3 <sub>(200A)</sub>	CAT B3 <sub>(500A)</sub>	CAT C1 <sub>(3K)</sub>
100W 120/240	1 Phase Wye, 3-Wire + Ground	150/300	400	500	400	800	362	476	540
100W 120/208	3 Phase Wye, 4-Wire + Ground	150/300	400	500	400	800	362	476	540
100W 240	3 Phase Delta, 3-Wire	300	N/A	N/A	N/A	800	832	936	952
100W 240/120	3 Phase Delta, 4-Wire + Ground	300/150	700/400	800/500	400	1500/800	362/504	476/628	540/796
100W 220/380	3 Phase Wye, 4-Wire + Ground	320/640	800	900	800	1500	576	780	992
100W 277/480	3 Phase Wye, 4-Wire + Ground	320/640	800	900	800	1500	576	780	992
100W 480	3 Phase Delta, 3-Wire	640	N/A	N/A	N/A	1500	1640	1780	1820
100W 347/600	3 Phase Wye, 4-Wire + Ground	390/780	900	900	900	1800	584	772	1040
100W 600	3 Phase Delta, 3-Wire	780	N/A	N/A	N/A	1800	1320	1480	1600

Titan, Sine Wave Tracker and LightningTemp are trademarks of EFI Electronics Corporation

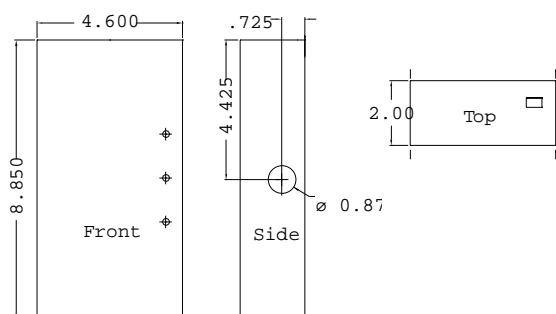

For company and product information, please visit [www.efinet.com](http://www.efinet.com)